

## Power Extension Cable Kit (220205-000, 220206-000, 220207-000)

Use the 210219-XXX truck mount cable if your vehicle has an existing power connector (Figure 1a, 1b) that was previously installed for a printer or for accessories. The part numbers (P/Ns) vary based on the length of the cable: part number 210219-036 is the 3 foot cable; 210219-072 is the 6 foot cable; and 210219-120 is the 10 foot cable.

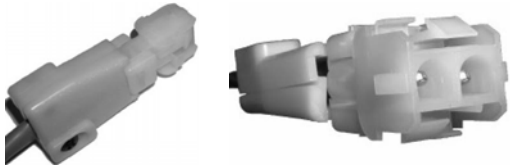

Figure 1a, 1b: Power Connector

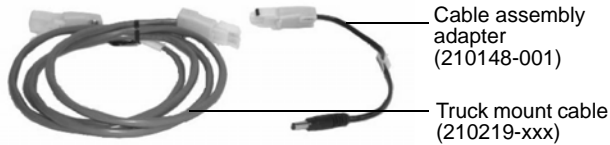

Figure 2

### Parts List:

- (1) Truck mount cable (P/N 210219-XXX)
- (1) Cable assembly adapter (P/N 210148-001)
- (1) Instruction sheet (not shown)

## Fuse Box Power Extension Cable Kit (220210-000)

Use the 210122-000 fuse box, truck mount cable if your vehicle does not have an existing power connector.

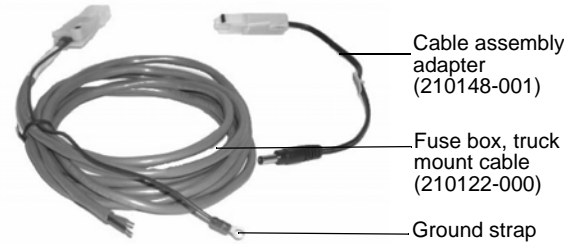

Figure 3

### Parts List:

- (1) Truck mount cable (P/N 210122-000)
- (1) Cable assembly adapter (P/N 210148-001)
- (1) Instruction sheet (not shown)

## General Guidelines

- Route the truck mount cable so that the driver is not endangered and the cable does not harm, or interfere with, other equipment.
- The cable's routing should not cause damage to the truck mount cable.
- Do not route the cable in such a way that it could possibly be pinched, stepped on, or overheated.
- Do not expose the cable to moisture.
- Do not use the truck mount cables if your vehicle has a 24 volt output.
- If the truck mount cable must pass through a firewall, drill a 9/16" hole in the firewall and install a nylon bushing (not included).
- Do not attempt to defeat or bypass the inline fuse. Bypassing the inline fuse can be dangerous and may cause damage to your vehicle.
- Datamax-O'Neil does not warrant existing connector installations.
- Datamax-O'Neil does not assume liability for any damages resulting from improper installations, from installing to existing connectors, or from not following the instructions described in this instruction sheet.

## Step 1: Checking the Vehicle's Electrical System

If your vehicle's voltage is too high or too low, the printer may not work. Perform the following to check your vehicle's electrical system:

1. Measure your vehicle's battery voltage with a voltmeter. The voltage should be approximately 13 volts DC with the engine off.
2. Start your vehicle's engine.
3. Run your vehicle at a fast idle for 5 minutes while monitoring the battery's voltage. Normally, the voltage is less than 14.5 volts DC.

---

**Caution:** The battery's voltage cannot exceed 15.5 volts. If the battery's voltage exceeds 15.5 volts, there is a problem with your vehicle's electrical system that must be repaired before the printer will work properly. (A bad voltage regulator or a poor ground may cause excessive voltage.)

---

4. Depending on your installation, proceed to *Installing the Truck Mount Cable* or *Connecting the Truck Mount Cable to the Vehicle's Fuse Box*.

## Step 2a: Installing the Truck Mount Cable

**Caution:** Take voltage measurements before connecting the truck mount cable to the printer.

1. Route the truck mount cable from the general area where the printer is mounted and work toward your vehicle's existing connector using the information in the *General Guidelines* section.

**Note:** Try to route the truck mount cable following your vehicle's existing wiring. Use cable ties (not included) to join them.

2. Fasten the truck mount cable to the vehicle's sheet metal with cable retainers (not included). The truck mount cable should be secured or supported every 18 inches.

**Note:** Cable ties can be substituted for retainers.

3. If you are using the 210122-000 fuse box, truck mount cable, skip steps 4 and 5 and proceed to *Connecting the Truck Mount Cable to the Vehicle's Fuse Box*.
4. Connect the truck mount cable's plug to the existing power connector.
5. Measure the adapter's voltage at the connector end. Normally, the voltage is less than 14.5 volts. The voltage cannot exceed 15.5 volts.
6. Connect the adapter to the truck mount cable.
7. Connect the adapter to the printer (Figure 4).



Figure 4

## Step 2b: Connecting the Truck Mount Cable to the Vehicle's Fuse Box

Use the following procedure only if you are using the 210122-000 truck mount cable.

1. Route the truck mount cable from the general area where the printer is mounted and work toward your vehicle's fuse box using the information in the *General Guidelines* section.

**Note:** Try to route the truck mount cable following your vehicle's existing wiring. Use cable ties to join them.

2. Route the truck mount cable to your vehicle's fuse box and connect to a 10amp fuse. Make sure the cable routing produces a hazard-free installation. For more information, see *General Guidelines*.
3. Fasten the truck mount cable's ground strap to the vehicle's sheet-metal.
  - a. Use a #8 x 5/8 inch screw and a #8 flat washer. A stronger grip can be achieved by drilling a 9/64 drill bit/.140 inch hole and then punching it with a nail or punch to dimple and enlarge the opening.
  - b. Scrape a small circle of paint from around the hole to ensure a good electrical, ground connection.
4. Measure the adapter's voltage at the connector end. Normally, the voltage is less than 14.5 volts. The voltage cannot exceed 15.5 volts.
5. Connect the adapter to the truck mount cable.
6. Connect the adapter to the printer (Figure 5).



Figure 5

## Warranty

The Company warrants that Datamax-O'Neil products are free from defects in manufacturing materials and workmanship for one (1) year from date of original purchase to Buyer/Distributor (OEMs 90 days from the date of purchase). Batteries, cables, power supplies, and other accessories will be warranted for ninety (90) days. Datamax-O'Neil makes no other warranties, expressed or implied, including implied warranties of merchantability and fitness of purpose.

If you try to repair, disassemble, or change the product in any way, or use parts not provided by Datamax-O'Neil without prior, written authorization, all warranties are void.

For complete warranty and service information, see the Warranty Card included in your printer's original packaging.

## No Liability for Negligent Use

In no event shall Datamax-O'Neil be held liable for any damages whatsoever (including, without limitations, damages for loss of profits, business interruption, loss of information, or other pecuniary loss) arising out of negligence in use and care of the product.