

## 8600 Ring Scanner

---

### Quick Start Guide

Aller à [www.honeywellaidc.com](http://www.honeywellaidc.com) pour le français.

Vai a [www.honeywellaidc.com](http://www.honeywellaidc.com) per l'italiano.

Gehe zu [www.honeywellaidc.com](http://www.honeywellaidc.com) für Deutsch.

Ir a [www.honeywellaidc.com](http://www.honeywellaidc.com) para español.

Para Português, acesse [www.honeywellaidc.com](http://www.honeywellaidc.com).

Перейти на русскоязычный сайт [www.honeywellaidc.com](http://www.honeywellaidc.com).

Pro češtinu jdi na [www.honeywellaidc.com](http://www.honeywellaidc.com).

Pre slovenčinu choď na [www.honeywellaidc.com](http://www.honeywellaidc.com).

Türkçe için lütfen [www.honeywellaidc.com](http://www.honeywellaidc.com) sayfasını ziyaret ediniz.

Idź na stronę : [www.honeywellaidc.com](http://www.honeywellaidc.com) po quick start w języku polskim.

如要到中国 [www.honeywellaidc.com](http://www.honeywellaidc.com) (简体)。

إلى لانتق [www.honeywellaidc.com](http://www.honeywellaidc.com) للغة العربية.



## ***Laser Scanner.***

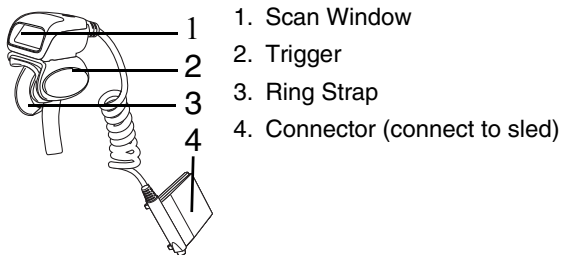

## ***Laser Imager***

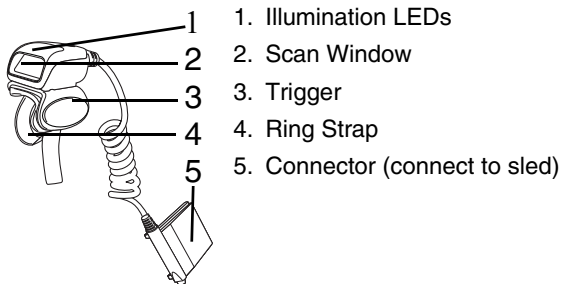

## ***Trigger Rotation***

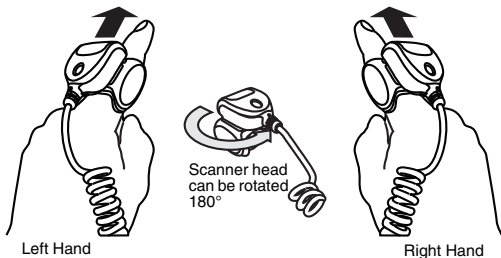

## ***Connect Scanner to Arm Mount Sled***

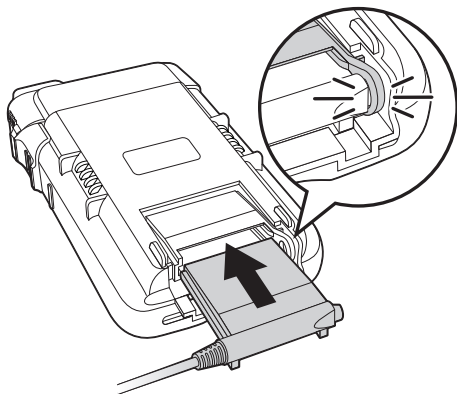

Slide the ring scanner cable connector into the bottom of the sled until the connector ring clicks shut.

# Attach Ring to Finger



Remove Shipping Film

Step 1 - Slide finger into loosened ring strap



Step 2 - Pulling ring strap to secure ring to finger

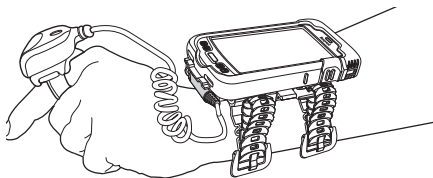

The ring cable should not cross under the hand.

# How to Scan a Bar Code

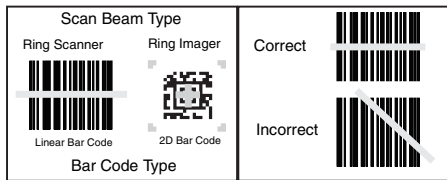
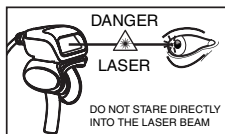

# Wrist Position When Scanning

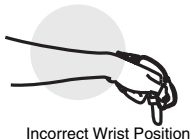

# Remove Ring Strap Module

Step 1 - Turn 90°.

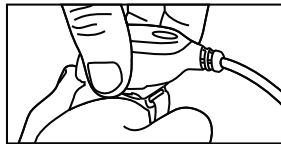
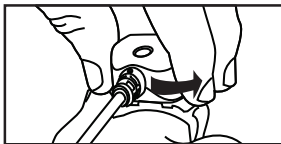

Step 2 - Press latch down.

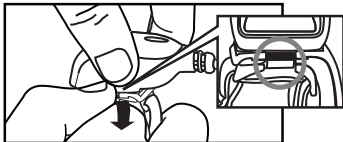

Step 3 - Remove the ring strap module.

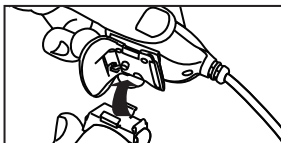

# Replace Ring Strap Module

Step 1 - Connect ring latch with trigger catch.

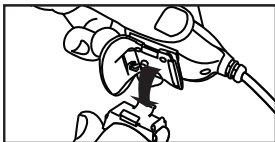

Step 2 - Press together until a click occurs.

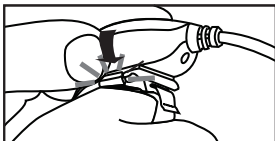

Step 3 - Turn 90°.

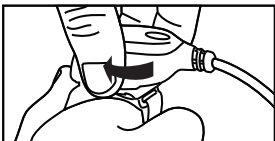

Step 4 - Ready to scan.

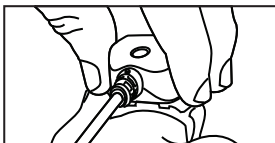

## Remove Trigger

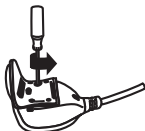

Step 1 - Remove the ring strap module. Turn the trigger until a black screw is visible. Remove the screw.



Step 2 - Turn the trigger 180°.

Step 3 - Lift the trigger up.

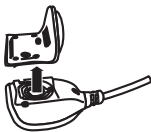

## Replace Trigger



Step 1 - Lower the trigger into the ring strap module as shown.



Step 2 - Turn the trigger 180°.

Step 3 - Insert and tighten the black screw.

Step 4 - Replace the ring strap module.

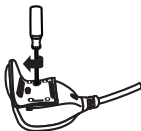



## ***Technical Assistance***

Contact information for technical support, product service, and repair can be found at [www.honeywellaidc.com](http://www.honeywellaidc.com).

## ***User Documentation***

For localized versions of this document, and to download the User's Guide, go to [www.honeywellaidc.com](http://www.honeywellaidc.com).

## ***Limited Warranty***

Refer to [www.honeywellaidc.com/warranty\\_information](http://www.honeywellaidc.com/warranty_information) for your product's warranty information.

## ***Patents***

For patent information, please refer to [www.honeywellaidc.com/patents](http://www.honeywellaidc.com/patents).

## ***Disclaimer***

Honeywell International Inc. ("HII") reserves the right to make changes in specifications and other information contained in this document without prior notice, and the reader should in all cases consult HII to determine whether any such changes have been made. The information in this publication does not represent a commitment on the part of HII.

HII shall not be liable for technical or editorial errors or omissions contained herein; nor for incidental or consequential damages resulting from the furnishing, performance, or use of this material.

This document contains proprietary information that is protected by copyright. All rights are reserved. No part of this document may be photocopied, reproduced, or translated into another language without the prior written consent of HII.

© 2015 Honeywell International Inc. All rights reserved.

Web Address: [www.honeywellaidc.com](http://www.honeywellaidc.com)